



REPAIR P3 FOLD FLAT DISPOSABLE RESPIRATOR

BI DIRECTIONAL RESPIRATOR - PROTECTS AGAINST SOLID & LIQUID PARTICLES INCLUDING OIL BASED MISTS

APPLICATIONS

Where protection is required to protect the wearer, and also the product/ environment this bi directional filter works both ways. Protects against Airborne viruses, Pharmaceutical dusts, bacteria, Legionella.

TECHNICAL SPECIFICATION

- Lightweight - 16g
- Filters 99.7% of airborne particulates
- Multi layered filter medium combining electrostatic charge
- Ergonomically shaped for comfort and ease of use
- Adjustable head straps to provide individual fit
- Adjustable nose clip to ensure good seal around nose
- Colour coded for ease of identification
- Individually packed complete with instructions for use
- Conforms to the European approved standard EN149:2001+A1:2009
- Non-allergenic
- Bi Directional filter protects the wearer and the patient

EN149 FFP3 20 x APF 50 xNPF (NR) provides a protection factor of 20 x A.P.F. (Assigned Protection Factor) and 50 x N.P.F. (Nominal Protection Factor)

INSTRUCTIONS FOR USE

Mask must be fitted in accordance with the instructions supplied. Care must be taken to ensure that the correct mask type is selected for the work to be carried out. If in doubt as to the type of mask required seek professional advice

LIMITATIONS OF USE

Protection will only be offered if the mask is fitted correctly. The mask must be discarded and replaced if it is a). Removed whilst in the contaminated area, b). Breathing difficulties due to clogging are experienced or, c). The mask becomes damaged.

The mask, when in contact with the skin may cause allergic reactions to susceptible individuals. If this occurs leave the hazard area, remove mask and seek medical advice.

USAGE

REPAIR 3 can be used in atmospheres containing particulates as defined in the current H.S.E. document EH40 to provide a level of protection of 20 x A.P.F. and 50 x N.P.F.

UNIQUE FILTER MATERIAL

The unique filter material provides an extremely low breathing resistance, and far exceeds the performance required by EN149:2001+A1:2009.

ERGONOMICALLY DESIGNED

Allows freedom of speech, an easy fit minimising leakage providing a high level of protection and comfort plus complete compatibility with all other forms of protective equipment giving an especially clear field of vision.

FITTING INSTRUCTIONS

1. Carefully unwrap mask. For Fold Flat & Slimline make sure mask flaps are unfolded fully.
2. Place the bottom headband over the head to the nape of the neck.
3. Place the mask under the chin, then over the nose.
4. Pull the top head band over the crown of the head.
5. Using both hands mould the nose band to the shape of your nose, do not pinch the nose band as this could create a break in the seal.
6. If available, use adjustable straps.

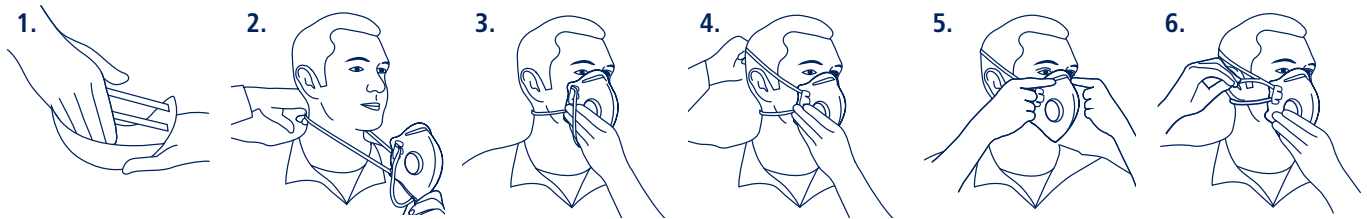

FIT CHECK

Check the fit of the mask by covering with both hands and exhale vigorously. Any leaks around the face seal must be eliminated before entering contaminated area.

INSTRUCTIONS FOR USE

1. Suitable for use against solid and liquid particulates including oil based mists.
2. This product does not protect against gases or where oxygen levels are below 17%.
3. Do not use when concentrations or contaminants are unknown or dangerous to life.
4. Leave the work area if distress or dizziness occurs.
5. Do not alter or modify the product in any way.
6. This product is intended only for single use and must not be used for more than 8 hours. Replace mask if contaminated or if breathing becomes difficult.
7. Facial hair may affect the efficiency of the product.
8. Do not use in an explosive area.
9. Ensure the product is suitable for the intended use.
10. Place/protect the product when not in use within its packaging.
11. Store within +5° C - +32° C. Store at <80% RH.

FACE FIT TEST KITS & TESTING SERVICES



Why carry out face fit testing?

Over the years, awareness to Occupational Health has greatly improved. Misuse of Respiratory Protective Equipment (RPE) has been fairly commonplace. From facial hair interfering with the seal on the face to tearing off the bottom strap of the respirator, to burning holes in the filter, allowing the wearer to smoke through it, has been common practice.

Legislation, through the COSHH Approved Code of Practice (ACoP) has been put in place in an attempt to eliminate this abuse and improve awareness even further. This Face Fit Test Kit has been developed using the structure as laid down in HSE 282/28 Document. The Health and Safety Executive (HSE) suggest that Qualitative Face Fit Testing should be conducted on all 'tight fitting' filtering face pieces and half mask respirators.

How we can help

A qualified member of our team can visit your premises to carry out the face fit test to ensure the complete safety of your staff. We are able to test as many pieces of equipment as you like during our visit using our face fit testing kit.

How it works

The nebuliser produces a mist measuring approximately 5 microns. If the wearer tastes the substance, the seal has been broken and the wearer must be re-tested. This is a perfectly safe process which could save someone's life.

Contact us to discuss Face Fit Testing.